

PRIME RETAIL - PORTSMOUTH, NH 1465 Woodbury Avenue

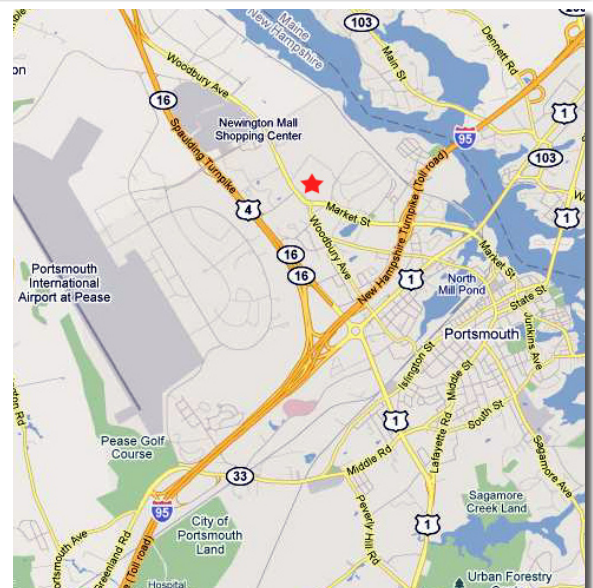

Property Information

- Up to 3,820 sf pad site with site expansion approved, drive-thru allowed
- Planned kiosk & 3,000 sf pad site
- Market Basket anchored center, with co-tenants Marshalls, Kmart, Panera Bread, Petco, Hallmark, Supercuts, Sleepy's...
- 933 parking spaces
- Less than 1 mile from I-95, Spaulding Turnpike (Rt 16) and Pease International Tradeport
- ADT = 30,000 - Woodbury Avenue
- Regional retail hub



Contact Jeff Bruk - jbruk@boylstonrealty.com
978.657.4600

PRIME RETAIL - MARSHALLS PLAZA PORTSMOUTH, NH

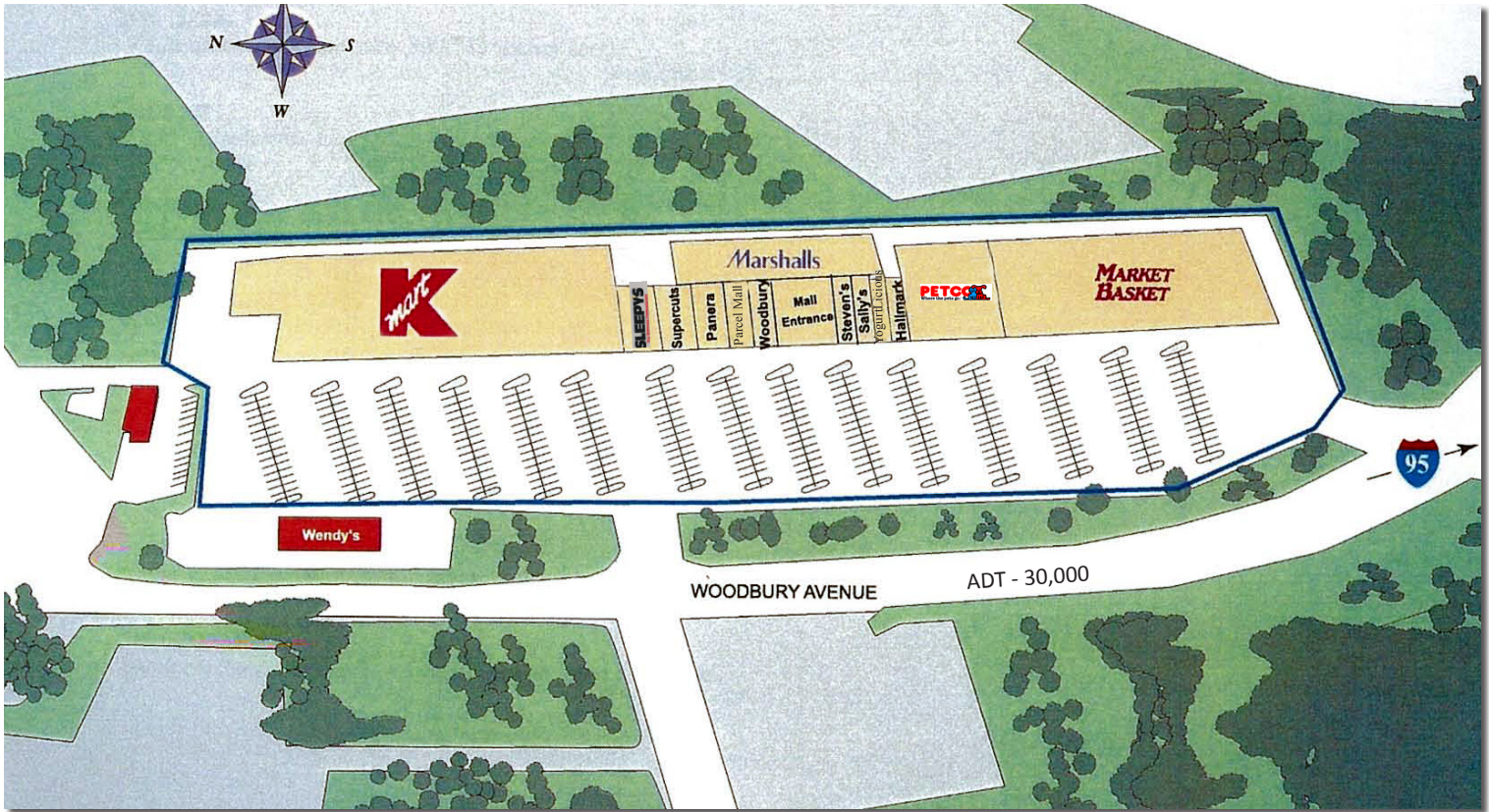

Trade Area Retailers

Walmart
 Trader Joe's
 Macy's
 Dicks Sporting Goods
 JC Penny
 HomeGoods
 Sears
 Babies "R" Us
 Jared Jewelers, Olympia Sports...



FOR MORE INFORMATION:

Jeff Bruk
 jbruk@boylstonrealty.com
 978.657.4600 x3131

Boylston Realty Advisors, Inc
 355 Middlesex Avenue, Suite 7
 Wilmington, MA 01887-2163
 978.657.4600
 boylstonrealty.com

Demographics

Radius	Population	Median HH Income	Average HH Income
1 mile	3,299	\$ 52,033	\$ 67,246
3 miles	23,417	59,530	74,594
5 miles	41,562	64,383	81,443

The information and images contained herewith have been obtained from sources deemed to be reliable. However, Boylston Realty Advisors makes no guarantee, warranty, or representation as to the accuracy or completeness thereof. Images shown may not be current and may be modified for illustrative purposes. 7-5-2011, 2-24-2012